

vtech[®]
Baby

Parent's Guide

Lullaby Sheep Cot Light



VTech understands that a child's needs and abilities change as they grow and with that in mind we develop our toys to teach and entertain at just the right level...

vtech Baby

Toys that will stimulate their interest in different textures, sounds and colours

I am...

...responding to colours, sounds and textures

...understanding cause and effect

...learning to touch, reach, grasp, sit-up, crawl and toddle

Birth-36 months



Pre-School

Interactive toys to develop their imagination and encourage language development

I want...

...to get ready for school by starting to learn the alphabet and counting

...my learning to be as fun, easy and exciting as can be

...to show my creativity with drawing and music so my whole brain develops

3-6 years



Electronic Learning Computers

Cool, aspirational and inspiring computers for curriculum related learning

I need...

...challenging activities that can keep pace with my growing mind

...intelligent technology that adapts to my level of learning

...National Curriculum based content to support what I'm learning at school

4-10 years



To learn more about this and other VTech® products, visit www.vtech.co.uk

INTRODUCTION

Thank you for purchasing the **VTech® Lullaby Sheep Cot Light!**

Soothe baby into a peaceful sleep with the Lullaby Sheep Cot Light. This adorable sheep cot toy projects a relaxing image onto the ceiling to calm your little one as they go to sleep. Choose between two modes to play calming melodies and lullabies or relaxing sounds and shushing.

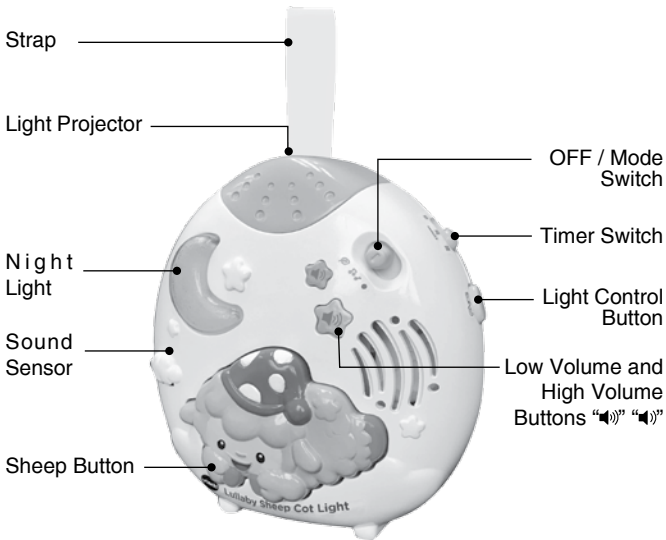

INCLUDED IN THIS PACKAGE

- One VTech® Lullaby Sheep Cot Light
- One attachment strap
- One parent's guide

WARNING: All packing materials, such as tape, plastic sheets, packaging locks, removable tags, cable ties and packaging screws are not part of this toy, and should be discarded for your child's safety.

NOTE: Please keep this parent's guide as it contains important information.

Unlock the packaging locks:

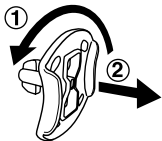

- ① Rotate the packaging locks anticlockwise for 90 degrees.
- ② Pull out the packaging locks.

GETTING STARTED

BATTERY INSTALLATION

1. Make sure the unit is turned **OFF**.
2. Locate the battery cover on the back of the sheep. Use a screwdriver to loosen the screw.
3. Install 3 new AA (LR6/AM-3) batteries following the diagram inside the battery box. (The use of new alkaline batteries is recommended for maximum performance).
4. Replace the battery cover and tighten the screw to secure it.

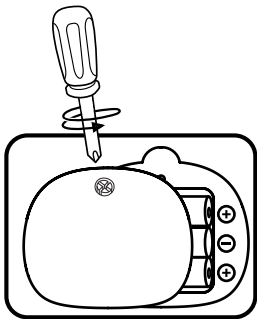

BATTERY NOTICE

- Use new alkaline batteries or fully charged NI-MH (Nickel Metal-hydride) rechargeable batteries for best performance.
- Use only batteries of the same or equivalent type as recommended.
- Do not mix different types of batteries: alkaline, standard (carbon-zinc) or rechargeable, or new and used batteries.
- Do not use damaged batteries.
- Insert batteries with the correct polarity.
- Do not short-circuit the battery terminals.
- Remove exhausted batteries from the toy.
- Remove batteries during long periods of non-use.
- Do not dispose of batteries in fire.
- Do not charge non-rechargeable batteries.
- Remove rechargeable batteries from the toy before charging (if removable).
- Rechargeable batteries are only to be charged under adult supervision.

Disposal of batteries and product



The crossed-out wheellie bin symbols on products and batteries, or on their respective packaging, indicates they must not be disposed of in domestic waste as they contain substances that can be damaging to the environment and human health.



The chemical symbols Hg, Cd or Pb, where marked, indicate that the battery contains more than the specified value of mercury (Hg), cadmium (Cd) or lead (Pb) set out in Battery Directive (2006/66/EC).



The solid bar indicates that the product was placed on the market after 13th August, 2005.

Help protect the environment by disposing of your product or batteries responsibly.

For more information, please visit:

www.recycle-more.co.uk

www.recyclenow.com

NOTE:

With the **VTech® Lullaby Sheep Cot Light** comes first.

To ensure your child's safety, the assembly of this product is an adult activity, not a child's activity. Please ensure that the cot attachment strap is securely locked into position to avoid injury. Follow the instructions below carefully and make sure the final assembly is correct. Attach only to cots with sturdy rails and spindles. Do not attach to playpens with mesh walls.

Please make sure the cot attachment strap is out of reach from children when placed in the cot. Please ensure the cot light is positioned in the upright position with the projection light facing directly upwards.

Please remove the cot attachment strap from the unit when the unit is going to be used outside the cot. The cot attachment strap should not be given to your child.

ASSEMBLY INSTRUCTIONS

With the VTech® Lullaby Sheep Cot Light, safety comes first. To ensure your child's safety, adult assembly is required.

1. Place the unit in the cot bringing the strap over the top rail. Slip the top of the strap under the slot on the back

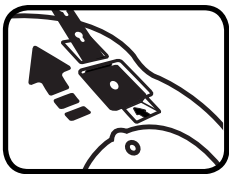
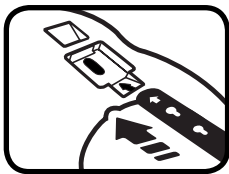

2. Place the unit in the cot bringing the strap over the top rail. Slip the top of the strap under the slot on the back of the unit and secure. You can adjust the hanging height by choosing the appropriate hole on the top of the strap.
3. Pull slightly on the unit to make sure the strap has been securely fastened. The unit should be snug against the cot rail. Please check the unit frequently to ensure it is still secure.

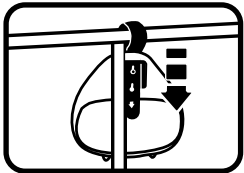
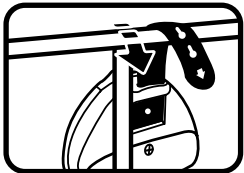

This product is in try-me mode in the packaging. After opening the package, turn the unit off and on again to proceed with normal play. If the unit repeatedly powers down quickly we suggest changing the batteries.

PRODUCT FEATURES

1. Off/Mode Switch

To turn the unit **ON**, slide the **OFF / Mode Switch** to select either **Lullaby Mode** (🎵) or **Sound Mode** (🔊). To turn the unit **OFF**, slide the **OFF / Mode Switch** to the **OFF** (●) position.



2. Volume Controls

To adjust the volume, press the **Low Volume button** (🔊) or the **High Volume button** (🔊🔊).



3. Timer Switch

Slide the **Timer Switch** to select the desired shut off time. Once the set time is up, the unit will enter sleep mode. Time options include 10, 20 or 30 minutes.



4. Light Control Button

Press the **Light Control Button** to choose between the night light and the light projection.



5. Sheep Button

Press the **Sheep Button** to play the next sound, melody or sing-along song depending on the selected mode.

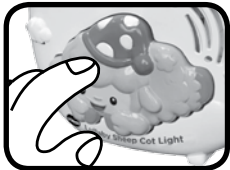

6. Night Light

If the Night Light is turned **ON** and the Light Projector is turned **OFF**, the Night Light will stay turned **ON** for approximately 30 minutes after the set time is up.

7. Sound Sensor

The **VTech® Lullaby Sheep Cot Light** is equipped with a special **Sound Sensor**. Once the set time is up, the unit will automatically shut off. The sensor will reactivate the program when it detects baby's cry for approximately 2 seconds without interruption. The unit will reactivate and play lullabies or nature sounds depending on the selected mode.

8. Automatic Shut Off

To preserve battery life, the **VTech® Lullaby Sheep Cot Light** will automatically shut off after the timer has expired. The unit can be reactivated by pressing any button, sliding the mode switch or timer switch, or when baby cries.

NOTE: If the unit powers down while playing, we suggest changing the batteries.

ACTIVITIES

1. To turn the unit **ON**, slide the **OFF / Mode Switch** to select either **Lullaby Mode** (🎵) or **Sound Mode** (🔊). You will hear sing-along songs and soothing melodies in Lullaby Mode, or soothing sounds in Sound Mode. The projector will light up and the night light will shine.
2. Press the **Sheep Button** to play the next sound, melody or sing-along song depending on the selected mode.



MELODY LIST

1. Ave Maria - Schubert
2. The Blue Danube - Strauss
3. Beautiful Dreamer
4. Cradle Song - Mozart
5. Clair de lune - Debussy
6. Canon in D - Pachelbel
7. Minuet in G Major - Beethoven
8. Berceuse Op. 57 - Chopin
9. String Quintet in E Major Op. 11, No. 5 - Boccherini
10. Moonlight Sonata - Beethoven
11. Swan Lake - Tchaikovsky
12. Nocturnes, Op. 9, No. 2 - Chopin
13. Kinderszenen - Schumann

14. Brahms' Lullaby
15. Ode to Joy
16. Turkish March - Mozart
17. Piano Sonata No. 16 - Mozart
18. Serenade for Strings Op. 3 No. 5 - Haydn
19. Fur Elise - Beethoven
20. Cello Suite No. 1 in G Major - Bach
21. All Through the Night
22. Baa, Baa, Black Sheep
23. Did You Ever See a Lassie?
24. Swing Low, Sweet Chariot
25. Hush, Little Baby
26. Goodnight, Ladies
27. London Bridge
28. Are You Sleeping? (Frère Jacques)
29. Clementine
30. Danny Boy
31. My Bonnie Lies Over the Ocean
32. Do Your Ears Hang Low
33. My Wild Irish Rose
34. Bicycle Built for Two
35. Ride a Cock Horse to Banbury Cross
36. Rock-a-bye Baby
37. Sleep, Baby, Sleep
38. An Irish Lullaby
39. Take Me Out to the Ball Game
40. Oh When the Saints Go Marching In

SING-ALONG SONG LYRICS

SONG 1

Are you sleeping, Are you sleeping?
Brother John? Brother John?
Morning bells are ringing, morning bells are ringing.
Ding, ding, dong. Ding, ding, dong.

SONG 2

Twinkle, twinkle, little star.
How I wonder what you are.
Up above the world so high,
like a diamond in the sky.
Twinkle, twinkle, little star.
How I wonder what you are.

SONG 3

Stars in the sky, peaceful moonlight,
Yawn *Yawn* sleep tight, goodnight.

CARE & MAINTENANCE

1. Keep the unit clean by wiping it with a slightly damp cloth.
2. Keep the unit out of direct sunlight and away from any direct heat source.
3. Remove the batteries when the unit will not be in use for an extended period of time.
4. Do not drop the unit on hard surfaces and do not expose the unit to moisture or water.

TROUBLESHOOTING

If for some reason the program/activity stops working or malfunctions, please follow these steps:

1. Please turn the unit **OFF**.
2. Interrupt the power supply by removing the batteries.
3. Let the unit stand for a few minutes, then replace the batteries.
4. Turn the unit **ON**. The unit should now be ready to play with again.
5. If the product still does not work, install a brand new set of batteries.

If the problem persists, please call our Consumer Services Department at 01235 546810 (from UK) or +44 1235 546 810 (outside UK), and a service representative will be happy to help you.

IMPORTANT NOTE:

Creating and developing **VTech®** products is accompanied by a responsibility that we take very seriously. We make every effort to ensure the accuracy of the information, which forms the value of our products. However, errors sometimes can occur. It is important for you to know that we stand behind our products and encourage you to call our Consumer Services Department on at 01235 546810 (from UK) or +44 1235 546 810 (outside UK), with any problems and/or suggestions that you might have. A service representative will be happy to help you.

**CLASS 1
LED PRODUCT**



PRODUCT REGISTRATION

Visit www.vtech.co.uk/clubvtech/login
to register your VTech product

By joining the VTech Club you can also enter competitions, find out about news and events, seek expert advice for parents and let your kids play fun learning games and activities.



PRODUCT WARRANTY

Thank you for choosing this quality product from VTech. We hope it will bring many hours of entertainment, imaginative play and learning.

1. The product detailed above is covered by a one year warranty from the date of purchase, against any defects in materials or workmanship.
2. The product may be returned to the place of purchase. Alternatively the product can be returned to VTech Electronics Europe plc (see address below), with proof of purchase, without proof of purchase no replacement will be provided.
3. VTech Electronics Europe plc will examine the product and if it is found to be defective due to faulty materials or workmanship, will replace the product at their discretion.
4. If the product covered by this warranty is damaged due to misuse, modification or unauthorised repair, or because of faulty batteries, battery discharge or incorrect electrical connections, then this warranty becomes void.
5. This warranty is personal to the original purchaser and is not transferable.
6. Breakages to the LCD screen are not covered by the warranty.
7. Returns to VTech Electronics Europe plc should include a cheque or postal order for £1.50 towards the cost of return postage and packaging.
8. Products returned to VTech Electronics Europe plc, should be addressed as follows and packed carefully to avoid damage in transit (Please do not include batteries or adaptor). Please include details of the fault together with your name and address.
9. To keep an online record of your warranty, please register your product online at www.vtech.co.uk/warranty

Vtech Electronics EU PLC, c/o XPO Logistics, Warehouse 350, Cat & Fiddle Lane, West Hallam, DE7 6HE

THIS WARRANTY IS OFFERED AS AN EXTRA BENEFIT AND DOES NOT AFFECT CONSUMERS' STATUTORY RIGHTS.

This warranty is valid for the UK and Eire only. For products purchased outside the UK and Eire, please contact your local distributor or place of purchase.



**Visit our website for more
information about our products,
downloads, resources and more.**

www.vtech.co.uk

